



Noise From the Power Steering Pump

SYMPTOM

Noise from the power steering pump.

PROBABLE CAUSE

Insufficient bearing grease.

CORRECTIVE ACTION

Replace the power steering pump bearing and seal.

PARTS INFORMATION

Power Steering Pump Bearing:

P/N 91048-P2A-003, H/C 4781050

Power Steering Pump Shaft Seal:

P/N 91249-P2A-003, H/C 4781068

O-ring (15.2 x 2.4 mm):

P/N 91347-P2A-003, H/C 4781076

O-ring (51.0 x 2.4 mm):

P/N 91348-P2A-003, H/C 4781084

Power Steering Pump Cover Seal (O-ring):

P/N 91349-P2A-003, H/C 4853081

REQUIRED MATERIALS

Genuine Honda Power Steering Fluid:

P/N 08206-9002, H/C 3747284

Steering Grease:

P/N 08733-B070E, H/C 2033702

WARRANTY CLAIM INFORMATION

In warranty: The normal warranty applies.

Operation Number: 512103

Flat Rate Time: 0.8 hour

Failed Part: P/N 91048-P2A-003
H/C 4781050

Defect Code: 042

Contention Code: B06

Template ID: 00-027A

Skill Level: Repair Technician

Out of warranty: Any repair performed after warranty expiration may be eligible for goodwill consideration by the District Service Manager or your Zone Office. You must request consideration, and get a decision, before starting work.

REPAIR PROCEDURE

1. Remove the power steering pump from the car. Refer to page 17-25 of the 1997-99 Prelude Service Manual.
2. Hold the power steering pump in a vise with soft jaws, hold the pulley with the special tool, and remove the pulley nut and pulley.

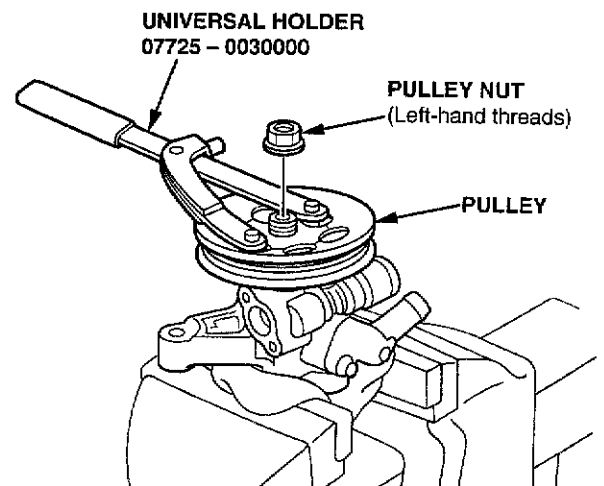
**058825**

- Disassemble the power steering pump. Don't disassemble the flow control valve, the inlet joint, and the sub-valve.

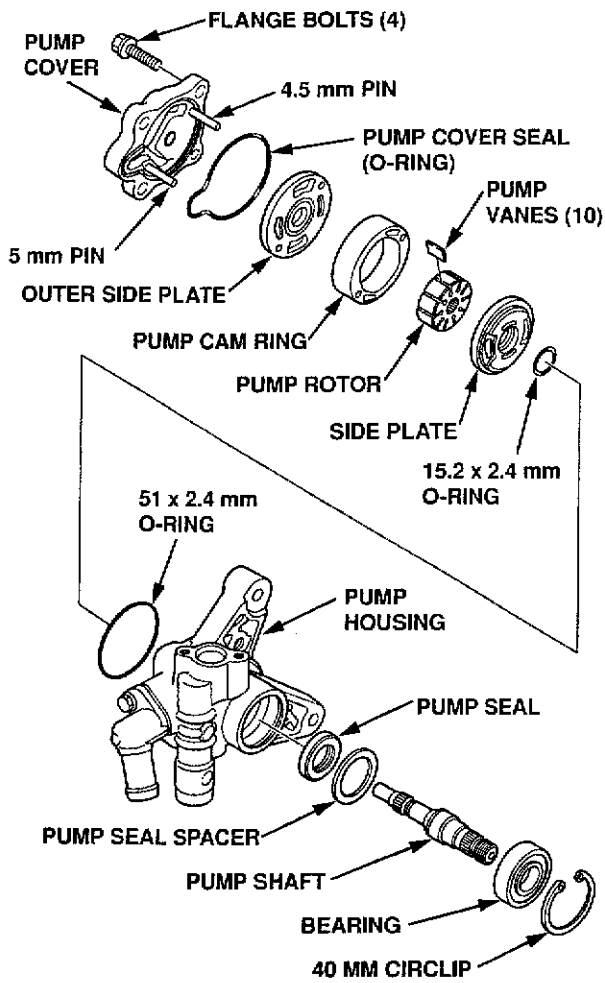

- Press the old bearing off the power steering pump shaft, then press the new bearing on.

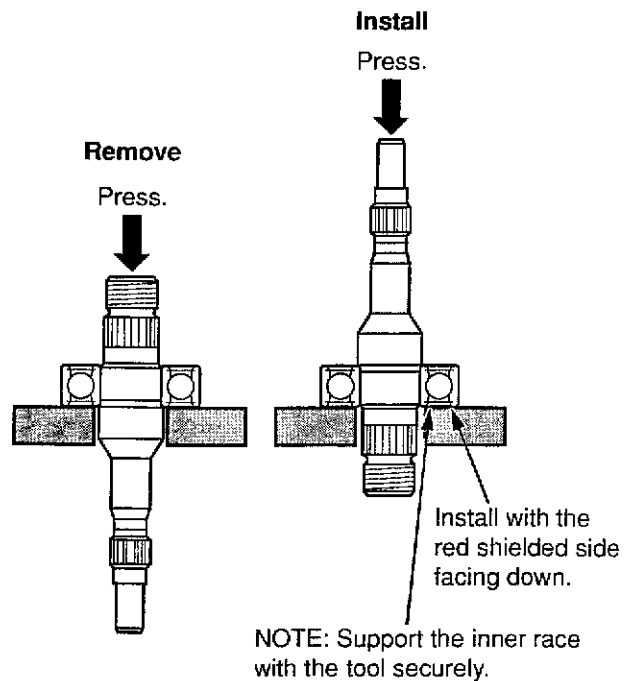

- Coat the lip of the new pump shaft seal with grease, then set it in the pump housing, grooved side facing in.

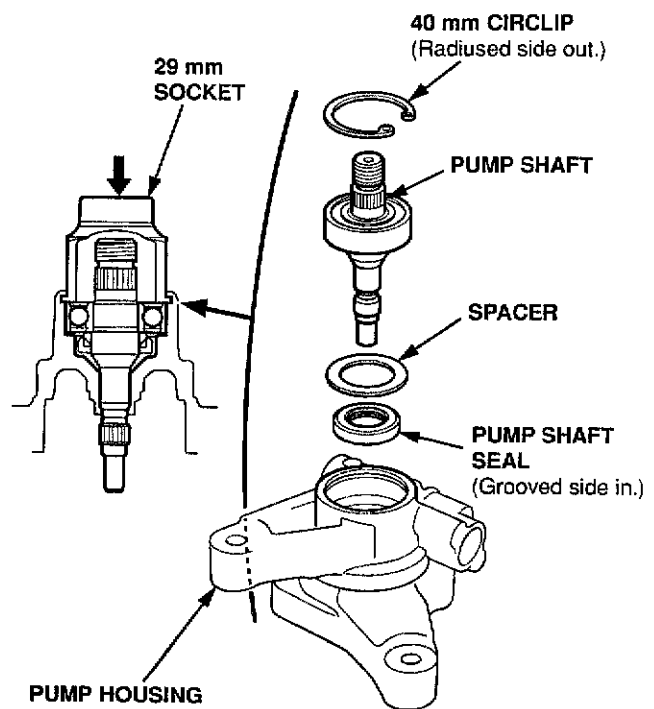

- Reinstall the shaft, spacer, and circlip in the pump housing with the radiused side of the circlip facing out.

7. Coat the pump cover seal (O-ring) and bushing with power steering fluid, then install the seal (O-ring) in the pump cover.

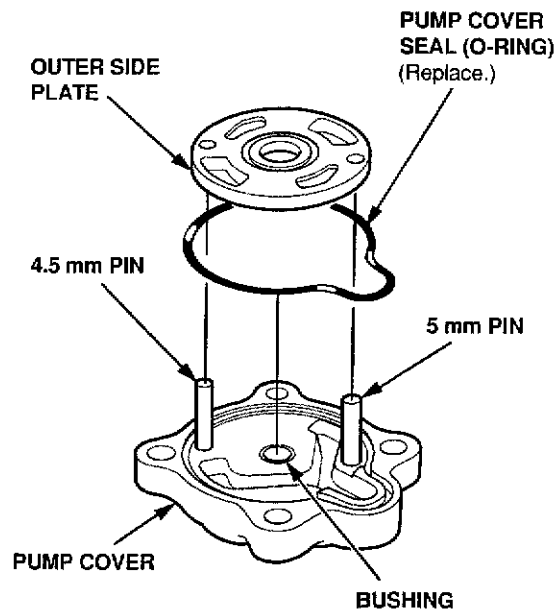

8. Install the outer side plate onto the pins.
9. Install the pump cam ring onto the pump cover pins. Make sure the "*" mark on the cam ring faces up.

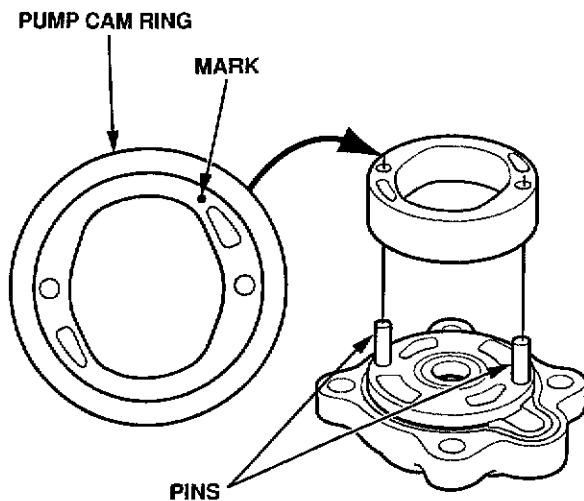

10. Set the pump rotor and the vanes in the cam ring. Make sure the round edge of each vane is facing out.

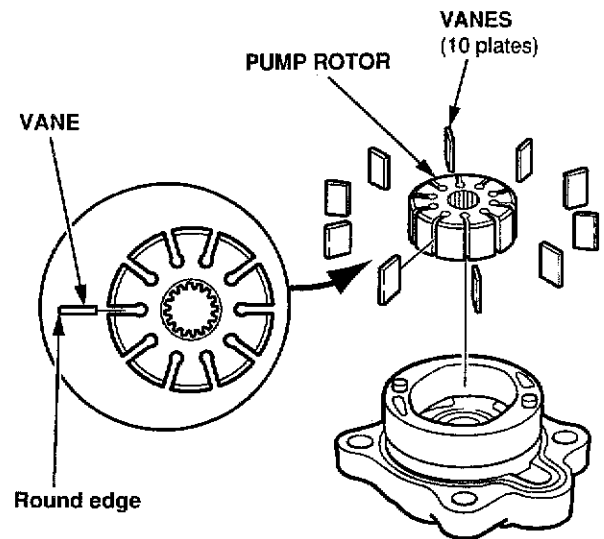

11. Coat the new 15.2 x 2.4 mm O-ring with power steering fluid, then install it in the side plate.

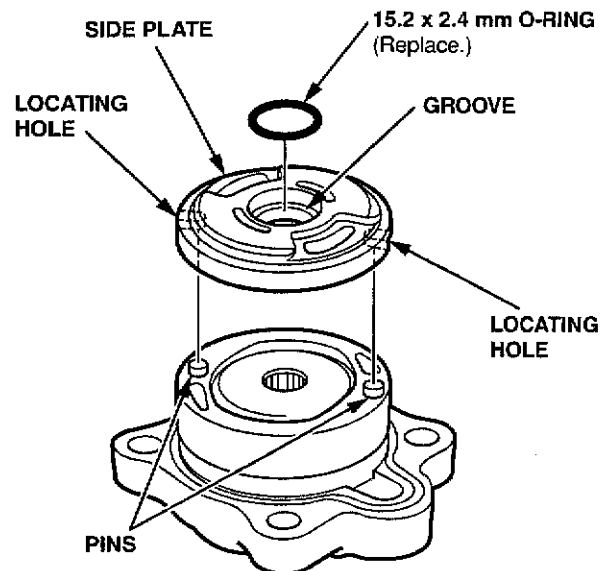

12. Install the side plate.

13. Coat the 51 x 2.4 mm O-ring with power steering fluid, and install it in the pump housing.

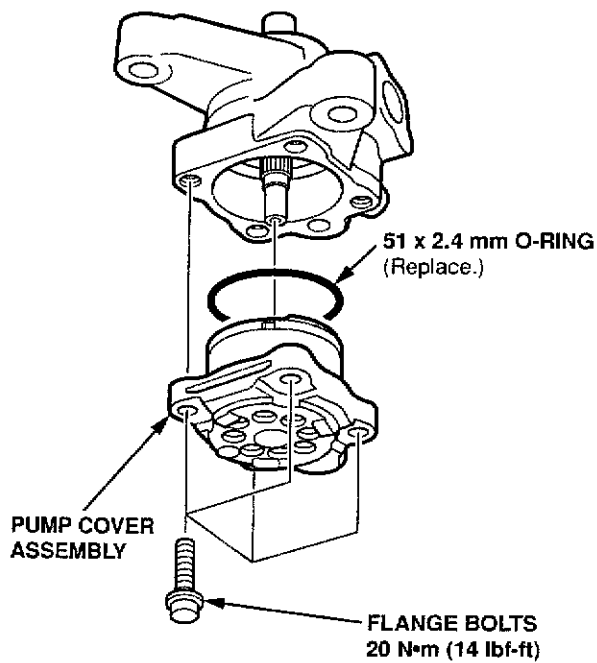

14. Slide the pump cover assembly onto the pump shaft, and secure it to the housing with the four bolts. Torque the flange bolts to 20 N·m (14 lb-ft).
15. Reinstall the pulley, and tighten the nut to 64 N·m (47 lb-ft).
16. Reinstall the power steering pump on the car.
17. Check the fluid level in the system. Add Genuine Honda Power Steering Fluid if necessary.
18. Bleed any air from the system, then recheck the fluid level.